

What's New in AccuRoute 6.6

Release Date: Dec. 15, 2022

Upland AccuRoute's latest product release focuses on further extending integrations and features most used by our current customers. We've added new features to enhance the user experience at the multi-function peripheral (MFP) by adding support for Lexmark and enabling users to browse their document management system (DMS) folders from the MFP panel. AccuRoute will also move to .NET 6.0 with this update, maintaining critical security standards while also introducing new capabilities for AccuRoute CloudFAX, such as the ability to delete fax images.

Integrations

Extended Folder Navigation at the MFP for DMS Integrations

AccuRoute has historically had the capability to let users drill down and browse the folders in certain repositories (known as Virtual Folders), such as DropBox or GoogleDocs. This release of AccuRoute extends this capability to iManage and NetDocuments, two more document management systems supported by AccuRoute. This update also allows users, with permission, the ability to include basic profiling information that is required when scanning to iManage and NetDocuments.

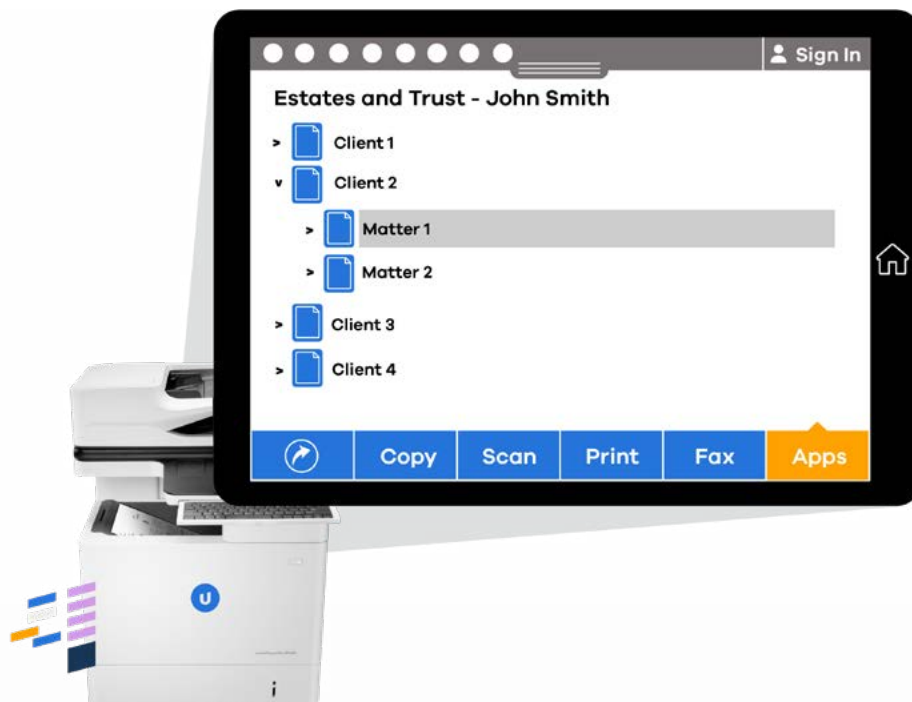

Integrations (continued)

Lexmark Device Support

With this release of AccuRoute, we are extending support for the Universal Device Client (UDC). The UDC is our universal experience for AccuRoute's device interface that allows sets of buttons and prompts to be populated and actionable from the device panel and will now be available on Lexmark Framework 5 and 6 devices.

OneDrive Organization Account Support

A popular feature of AccuRoute is the ability to scan to and print from Microsoft OneDrive. Historically, for a user to access OneDrive from the AccuRoute Client or the Upland MFP, they needed to "authorize" AccuRoute to utilize their OneDrive account. This process could either be started from the Upland MFP panel by creating a "token" that is then processed through the Microsoft website, or through the AccuRoute Client's authorization pages. With AccuRoute 6.6, organizations now have the ability to provide a single account that can access users' accounts that are provided by the organization. This approach eliminates the need for the users to perform this authorization in order to scan to or print from OneDrive.

Custom SharePoint URLs

Custom SharePoint URLs are set up by companies to make it easier for end users to find and use their organization's Microsoft SharePoint site, such as "MyCompanySharePoint.com." The AccuRoute SharePoint integration has been extended to support the integration with custom SharePoint URLs.

Email File and Attachment Drag and Drop

Having to download an attachment and then attach it to a new message within AccuRoute can be time consuming and inconvenient. With AccuRoute 6.6, users can now "drag and drop" email files onto their favorite WebApps tiles. Then users can upload the related email and attachment or just the attachment to the workflow based on configuration.

Sending and Retrieving Fax REST API

AccuRoute has a number of integration points, including the availability of a .NET, file scripting, and COM API that supports the ability to programmatically work with the software. With this release and based on customer requests, a new REST-based API has been added to support the sending of fax messages and retrieving the status of those messages from the AccuRoute software.

As REST APIs are HTTP(s) based, the functionality is built off the AccuRoute Client. REST APIs are a common API approach that eliminates a lot of network protocol headaches and traditional over-complexity by using the HTTP protocol for submit and response communication. This new capability allows for easier integration with other products and applications.



Security

.NET Core Update

Microsoft .NET Core is a core foundational component that supports the underlying capabilities of the AccuRoute Client. As Microsoft constantly is updating .NET Core, AccuRoute is required to keep current with a LTS (long-term support) version. AccuRoute will be updated to the latest .NET Core 6.X LTS version.

Fax Image Deletion

AccuRoute 6.6 has been updated to set the option to automatically delete fax images from storage regardless of success or failure. This feature requires faxes to be resubmitted if failed, as they will not be able to retry since the image has been deleted. Users can also access an auditable history that confirms the image has been deleted.

Data Loss Prevention and Detection (DLP) Trial License

Security and Compliance is a hot topic for organizations of all sizes and industries with large investments in monitoring and controlling communications and content flows. However, one area of content control that many businesses do not have a good solution for is scanned data and other electronic document content flows. AccuRoute is currently offering a DLP trial license to customers. These licenses will be temporary read-only licenses with access to Content Monitor features. With a trial license, customers will be able to test different key sequences, words, or phrases to see how much sensitive material is being handled by AccuRoute. The goal with this trial offer is to provide customers with the ability to analyze content and decide if purchasing permanent DLP licensing makes sense for their organization.

Administration and Account Management

Delegate and Assistant Manager

AccuRoute has the ability for people to send and receive on behalf of others, known as “delegates” and “assistants”. Historically, delegates and assistants were assigned by the user wanting to provide the delegate and assistant permissions or via the AccuRoute Administrator Client. This update provides AccuRoute Client users with the correct permissions to access a new set of configuration settings to assign delegates and assistance on behalf of users in an organization. This feature is a direct result of customer feedback requesting the ability to manage delegates and assistance on behalf of executives and lawyers who may not actively use the AccuRoute Client but still want their assistants to be able to send and receive faxes on their behalf.

Fax Channel Tracking

Based on AccuRoute customer input, the AccuRoute Administrator Dashboards have been updated with the ability to see the number of available fax channels, as well as the number of fax channels in sending and receiving states. The active number is now color coded to flag its usage compared to total available channels so that administrators can get a quick view of their active fax usage.



Administration and Account Management (continued)

Default Stamp

AccuRoute has a “Stamp” feature that allows documents to be stamped with text or images before they are delivered. For example, before documents are delivered to email or a repository, the AccuRoute Server can stamp the document with “confidential.” This functionality is currently available to be set through AccuRoute rules and by users in the AccuRoute Client. Historically, the AccuRoute Client only allowed for a default setting of no stamp, meaning the user must set the stamp each time they want it applied. With this update, the AccuRoute Client can now be set with different default options for users or entire organizations so that default stamps can be set.

Business Continuity

Disaster Recovery Automation

AccuRoute has disaster recovery (DR) options built in that allow for deployment configurations to handle major site disruptions that require a “failover” to a secondary site. Before this release, there were manual steps required by the AccuRoute administrator to force the disaster recovery data center switchover. At the request of customers using this feature, this release includes a DR-executable file for administrators to configure and edit DR settings through scripting. The file will allow administrators to perform the following tasks without the use of the server administrator to better support DR failover automation:

- Review Configuration Status
- Get Disaster Recovery component names
- Set primary and backup site values
- Initiate cutover
- Understand success and other return codes

Questions? Just reach out.



uplandsoftware.com/accuroute
email: accuroute-support@uplandsoftware.com

